

Developer :



Sita Mansion, 2.5 Mile, Sevoke Road, Siliguri-734001

website : [www.sbmgroupindia.com](http://www.sbmgroupindia.com)

Email : [info@sbmgroupindia.com](mailto:info@sbmgroupindia.com); [sbmslg@gmail.com](mailto:sbmslg@gmail.com)

Site :

Birsa Munda Bridge

Champasari Main Road , Near Himcoarse, Siliguri

Architect :

Raj Agarwal & Associates, Kolkata

Legal :

R.K. Agarwal & Associates, Siliguri

Marketing Agent :



Sanat Trade Centre, 1st Floor, Sevoke Road

Siliguri - 734 001, West Bengal, India

+91 97330 72222 (M), 91 97330 71111 (M)

Website: [www.siliguriproperties.com](http://www.siliguriproperties.com), Email: [siliguriproperties@gmail.com](mailto:siliguriproperties@gmail.com)

Finance Available at attractive interest rates from all leading Banks and Financial Institutes

Disclaimer

This is not a legal document, the plans and photographs are conceptual. The actual product shall vary according to the sole discretion of the developer. No claims shall be entertained by the developer depending on this material.

Design: Bedichee: 98311 55329

The logo for SBM Freshia, featuring the text "SBM" in green and "Freshia" in blue, with a colorful geometric icon to the right. Below the main text is the tagline "A fresh, anytime".

SBM  
Freshia  
A fresh, anytime



## Art of Fresh Living...



A dainty done up multistoried, surrounded by the humdrum of busy buzzing streets. Won't help you much if you want to live fresh. So move out. To where every morning is born of the sun. Every song of the life is in tune of the birds. Every step is cushioned by grass. And every breath is purified by the greens. Nature here rejuvenates you in each second. And your mind and body get enlivened by a fresh helping of energy. When you start feeling all this around you, that's when you know, you've mastered the art of Fresh Living.

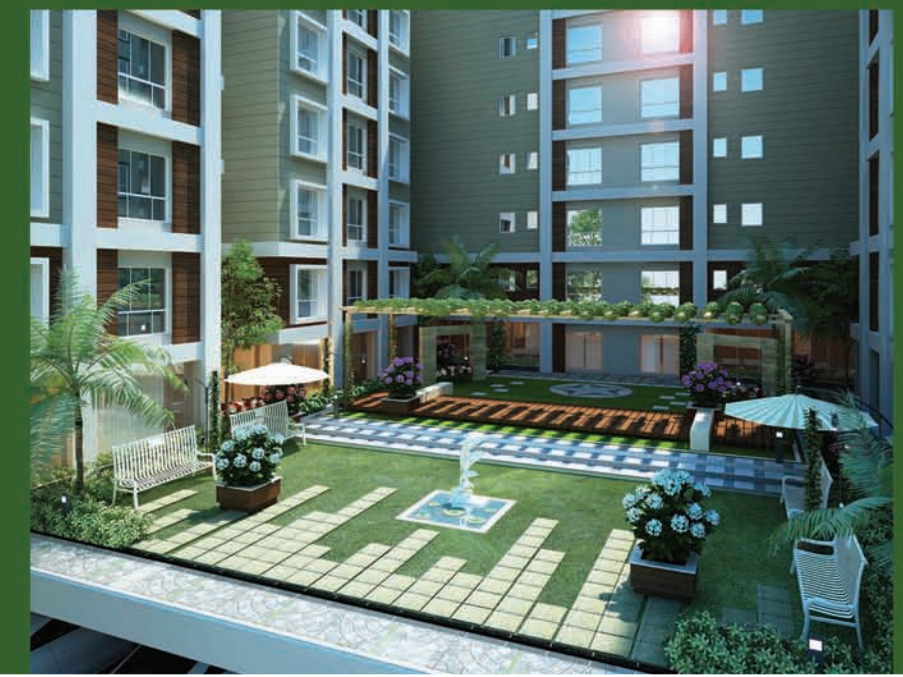





## Start life fresh

Every ounce of fresh life will seep into your body and mind at SBM Freshia, nature-homes from the SBM Group. As soon as you step in, a whiff of fresh inimitable energy will greet you. Every step that you take will bring your soul closer to the heart of nature. While the greens, blues and million other natural shades soothe your eyes, the whole feeling of being close to earthy life, will refresh your mind and body. Start life afresh at SBM Freshia a cluster of 148 lifestyle apartments spread over 80 Cottah approx.







Map Not to Scale



Lincoln's High School - 2km

Doon Heritage - 1 km

Tenzing Norgay Bus Terminus - 2.5 km

Medica North Bengal Hospital - 2.5 km

North Bengal Neuro Centre - 2.5 km

Bagdogra Airport - 15 km

New Jalpaiguri Railway Station - 7 km

City Centre Mall - 4 km

Neotia Getwell Hospital - 4 km

Local Market - 1km



## Stay at freshest location

A location, yet unexplored. Greenery yet untouched. Every unwanted city-element, strictly off limits. But every bit of connectivity, totally in touch. That's what defines this virgin location of SBM Freshia, where you will soon choose to make your home. Intertwined with nature, the living quarters here do not miss out on the excitement of city-life too. And the experience of living here, simply fresh and priceless. After all, where would you get a chance to live in a city and still not be in it?





## A fresh helping of greens

A beautiful Landscaped Garden and a generous bouquet of trees will greet you at SBMFreshia. With around 60% of Greenery in the project area, everyday will become a brand new day to you. The fresh breeze will play with your child at the children's playing area. Then you may take your afternoon break with your favourite book under the shade of big trees in the park. Go back to your childhood. Renew your life. Let the company of the spreading greens; transform your being as a whole.





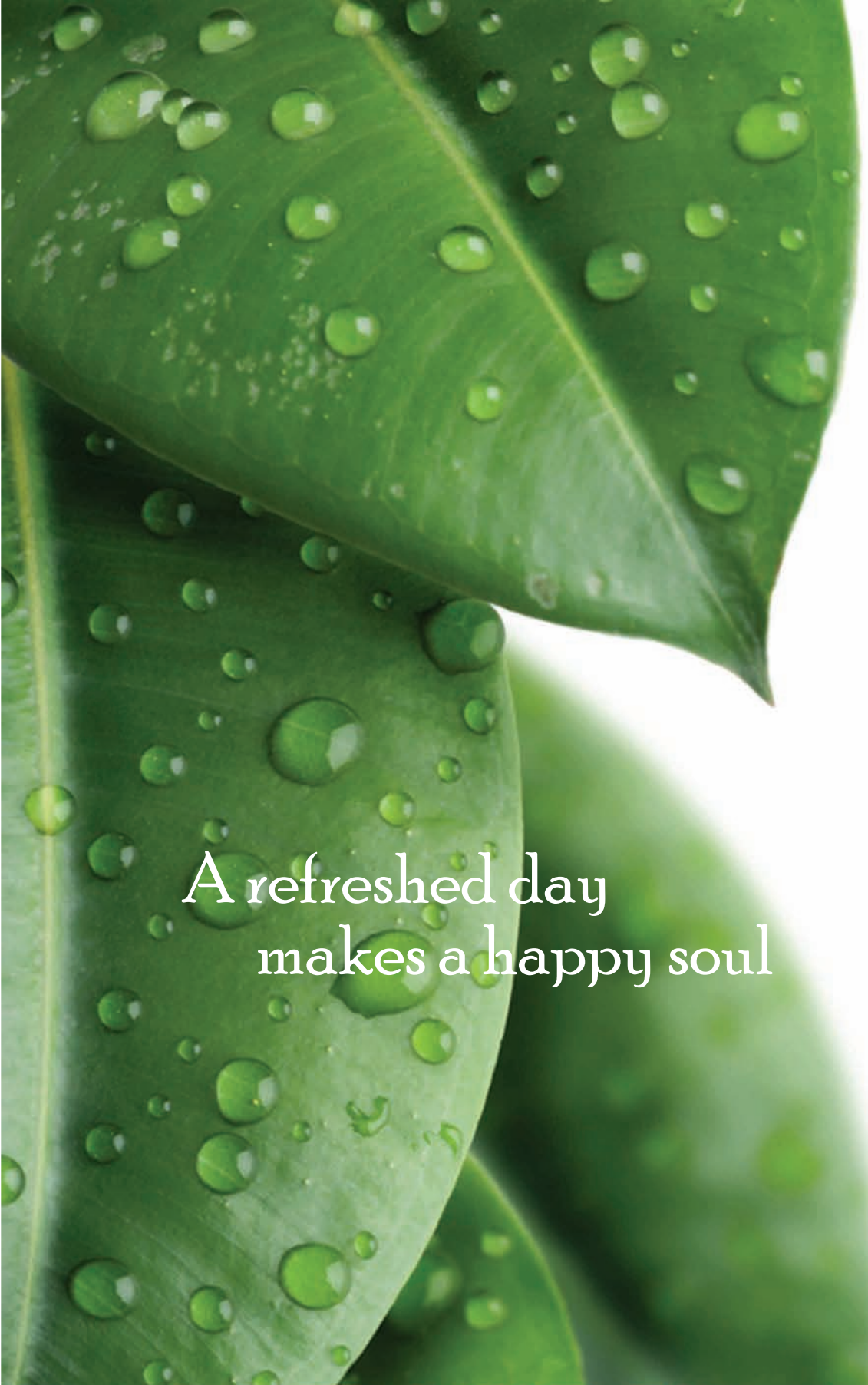

A refreshed day  
makes a happy soul



A hard day at work. There's F5- the club.  
A refreshing remedy for your weary soul. Sweat in out  
at your convenience at gym. Or surrender your body,  
mind and soul to the art of healing at the yoga &  
meditation area. Soak in a fresh bath at swimming pool  
or jam with people at community hall. Refresh!

- Multi Gym
- Pool table
- Table tennis
- Carrom Boards
- Card Playing Area
- Swimming pool
- AC Community hall
- Yoga Meditation Area
- Badminton court





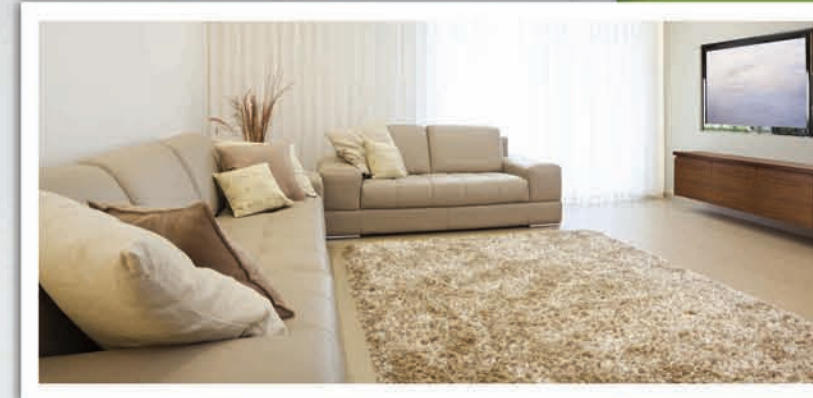
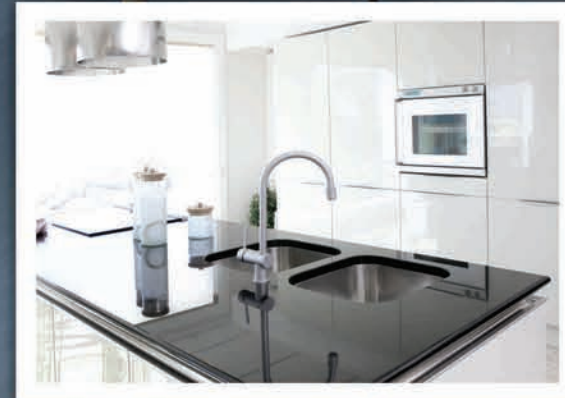
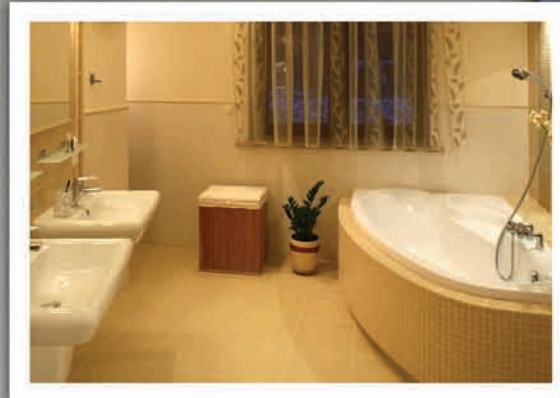

## Specifications

Structure: Earthquake resistant RCC Frames Structures.  
Walls: Brick for internal and external Walls.  
Elevation: Elegant looks with finished exterior paint/textured paints.  
External Wall finish: Combination of High Quality paint with textured paint.  
Internal Wall: Smooth finish with white putty of reputed brand.

### Doors/Windows:

Wooden door frame.  
32 mm thick flush door.  
Door fitted with branded hardware.  
Tower bolt in each door.  
34-series anodized aluminum sliding/fixing window fitted with high performance clear glass.

### Floorings:

Lobby: Selected quality Marble/Granite/Tiles with elegant design.  
Bedroom: Selected vitrified tiles of reputed brand.  
Hall: Selected vitrified tiles of reputed brand.  
Toilet/Kitchen: Selected anti skid ceramic tiles/Marble.

### Kitchen:

Counter: Selected granite top with S.S. sink of good quality.  
Wall: selected ceramic Tiles of reputed brand up to 2ft above the counter.  
Furnish: Modular kitchen fitted with chimney (optional at extra cost).

### Toilets:

Sanitary ware: Elegant white vitrified sanitary ware of reputed brand.  
C.P. fittings: Luxury Quality of Jaguar or equivalent brand.  
Wall Furnish: Selected ceramic tiles of reputed brand up to door height.

### Electricals:

AC Power Point: In Master Bedroom  
Cables: Fire resistant copper electrical conductors / cables.  
Switches: Elegant modular switches of reputed brand.  
Switchgears: MCB and ELCB and ACCL of reputed brand.





The best cared for Amenities will be present here to cater towards freshening up your soul.

- 24 x 7 Security
- Sewage Treatment Plant
- Power Backup\*
- CCTV
- Hi Speed lift
- Fire Fighting
- Intercom







## Fresh face of a seasoned developer

This living complex called SBM Freshia is the newest in line from the seasoned developer called the SBM Group. With an enviable portfolio in real estate spanning across the Siliguri Town, no one could have realised the concept of Freshia better.

Known all over, for its excellent architecture, brilliant understanding of topography and extremely efficient time management, the SBM Group is a potent power in the arena of real estate.

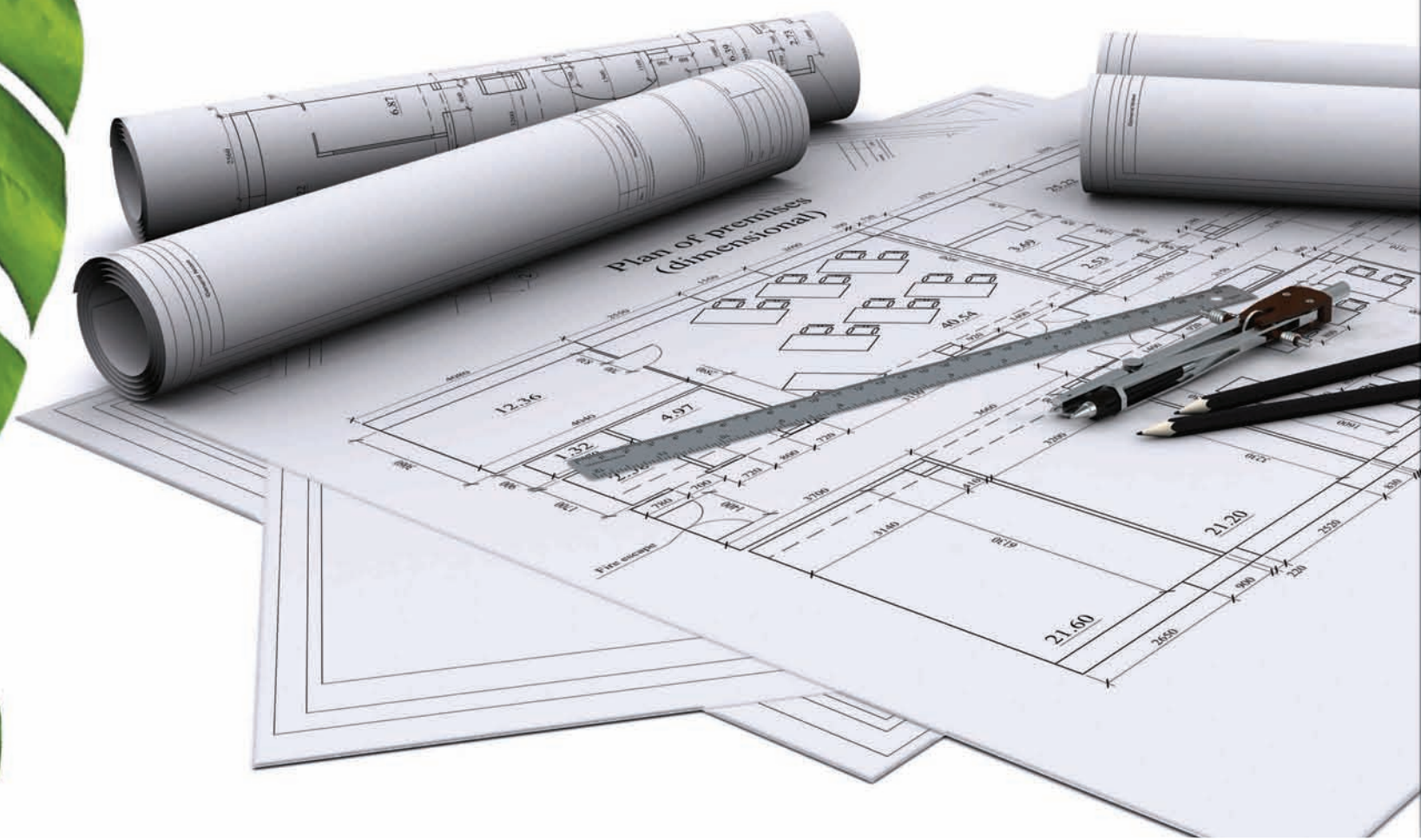

Past Projects



International Market



Panchnai Enclave



SBM Residency



SBM Arcade



SBM Height



SBM Bliss

On going Projects

Upcoming Projects



Typical Master floor plan



Typical floor plan (1st)  
Block-3 & 4





Typical floor plan (1st to 7th.)  
Block-1 & 2

Block-1

Block-2

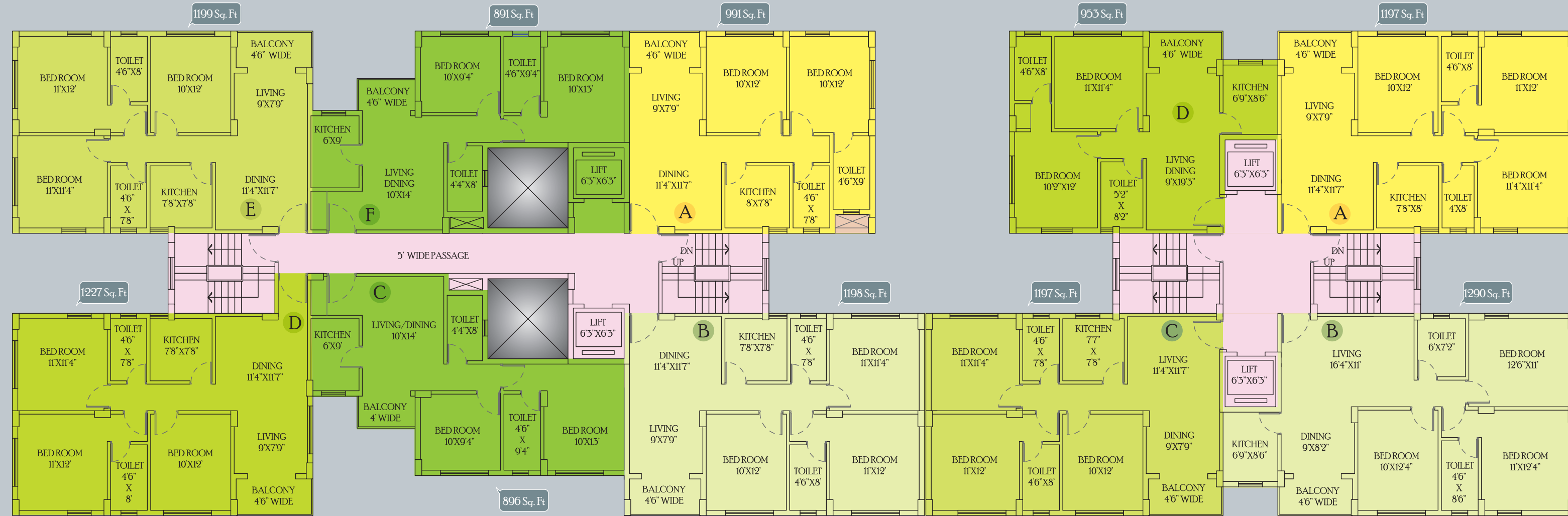



Typical floor plan (2nd to 7th.)  
Block-3 & 4



Block-3

Block-4

