



Developer

Kamakhaya Cold Storage Pvt. Ltd.
Sita Mansion, 2.5 Mile,
N.H 31, Sevoke Road,
Siliguri 734001

Site

SBM Residency
Beside Nirmala Convent School
3rd Mile, Sevoke Road, Siliguri 734001

Marketing Contact

+91 97331 88298
+91 97350 01254
+91 89000 49110
Email : sbmslg@gmail.com

Architect & Engineer

Chatterjee Associates
Bibek Kumar Chatterjee, B.Arch, M.Arch
Near Don Bosco School
2.5 Mile, Sevoke Road, Siliguri - 734001
Ph : +91 353 2542679
e-mail : chatterjee.bibek@gmail.com

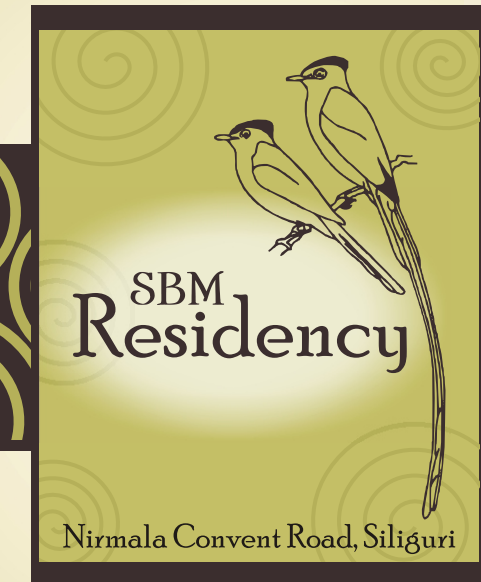
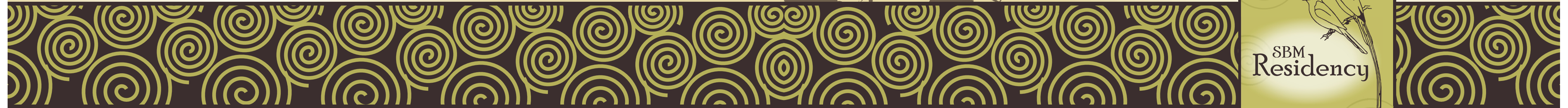

DISCLAIMER

The products / specifications / architectural drawings as mentioned are tentative and subject to change at the sole discretion of the company / Architect without any prior intimation to the customers. This is not a legal document, please refer to the legal terms and conditions / draft agreement of the company prior to finalization.

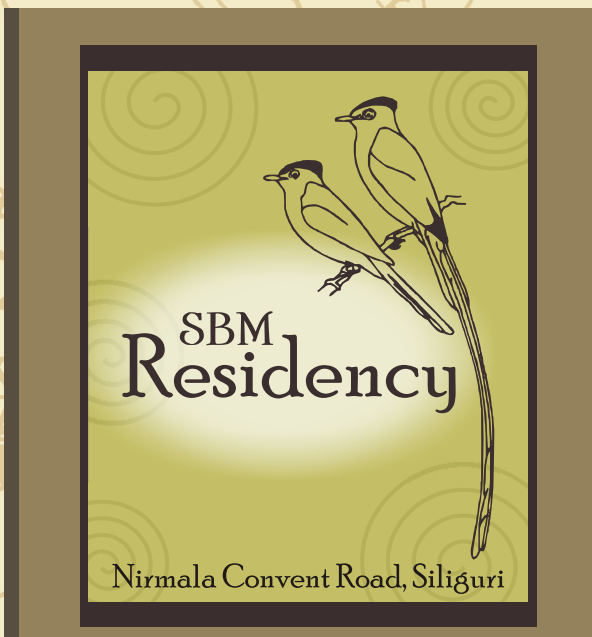
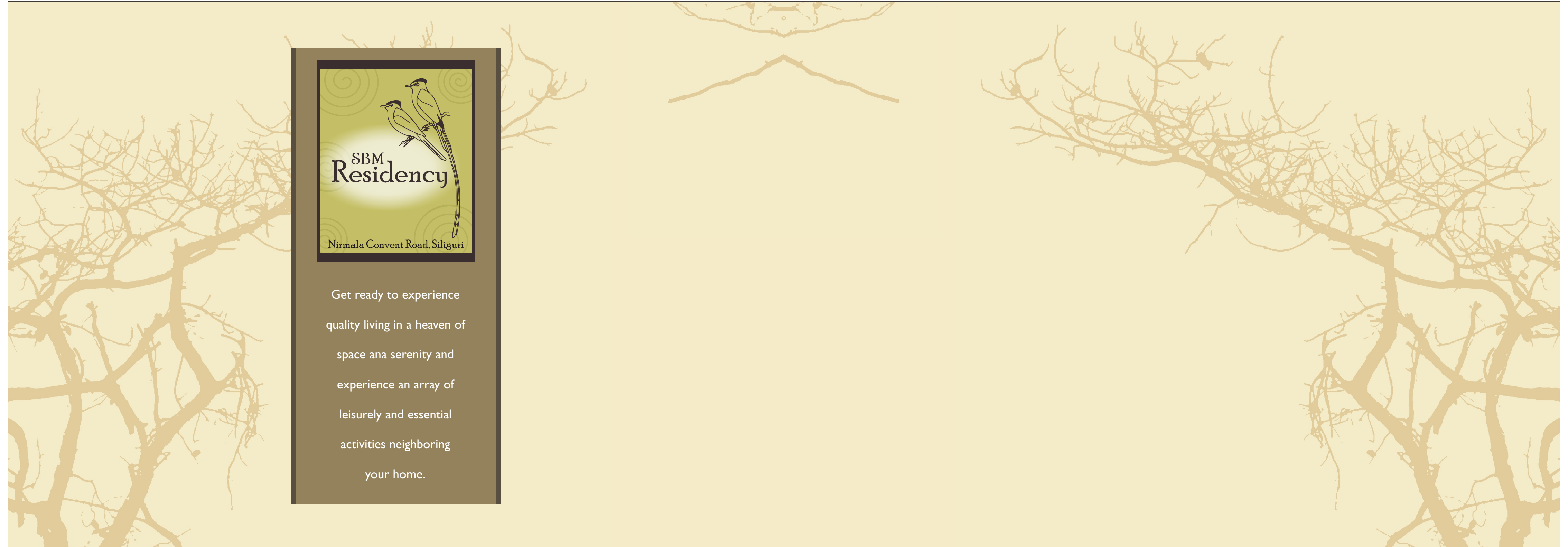

Get ready to experience
quality living in a heaven of
space and serenity and
experience an array of
leisurely and essential
activities neighboring
your home.



View by the roadside



Amenities



- Eco-friendly design with more than 50% Green/Open space.
- Landscaped garden with children's play area.
- 24 X 7 Security Service.
- CCTV and surveillance system in lobby.
- Intercom in each flat.
- Video Door Phone in each flat (At Owners cost).
- 24 X 7 water supply with water filtration system.
- Swimming pool.
- Fire fighting system.
- 4 nos. High speed automatic lift.
- 24 X 7 power back up through D.G. set (At owners cost).
- Gymnasium.
- A.C. Community hall.
- Well decorated lobby.
- Ample car parking. (At owners cost).



View by the poolside

Project Specification

- | | | |
|----------------------|---|-------------------------------------------------------------------|
| Structure | : | Earthquake resistant R.C.C. frame structure. |
| Walls | : | Bricks wall for exterior and interior walls. |
| External Wall Finish | : | Combination of textured and acrylic paint. |
| Internal Wall Finish | : | Smooth finish with white putty of reputed brand. |
| Doors | : | High quality flush door fitted with branded hardware. |
| Windows | : | 34-Series Anodised window fitted with high performance glass. |
| Flooring | : | |
| Bed Room | : | Selected Vitrified tiles of reputed brand. |
| Hall | : | Selected Vitrified tiles of reputed brand. |
| Toilet / Kitchen | : | Selected Anti skid ceramic tiles of reputed brand. |
| Lobby | : | Designed with selected Granite. |
| Kitchen | : | |
| Counter | : | Selected granite top with S.S. sink of reputed brand. |
| Wall | : | Selected ceramic tiles of reputed brand up to 2ft. above counter. |
| Furnish | : | Modular Kitchen fitted with Chimney (Optional). |
| Toilets | : | |
| Sanitaryware | : | Elegant white vitrified sanitaryware of reputed brand. |
| C.P. Fittings | : | Luxury quality of Jaquar or equivalent brand. |
| Wall Furnish | : | Selected ceramic tiles of reputed brand up to door height. |
| Electricals | : | |
| Cables | : | Fire resistant copper electrical conductors/cables. |
| Switches | : | Elegant modular switches of reputed brand. |
| Switchgears | : | MCB and ELCB and ACCL of reputed brand. |



Typical Floor Plan (First to Fourth Floor)

| Flat | Sizes |
|------|-------|
| A | 1602 |
| B | 1588 |
| C | 1505 |
| D | 1485 |
| E | 1893 |
| F | 1893 |
| G | 1602 |
| H | 1588 |
| I | 1505 |
| J | 1485 |
| K | 1602 |
| L | 1588 |
| M | 1505 |
| N | 1485 |

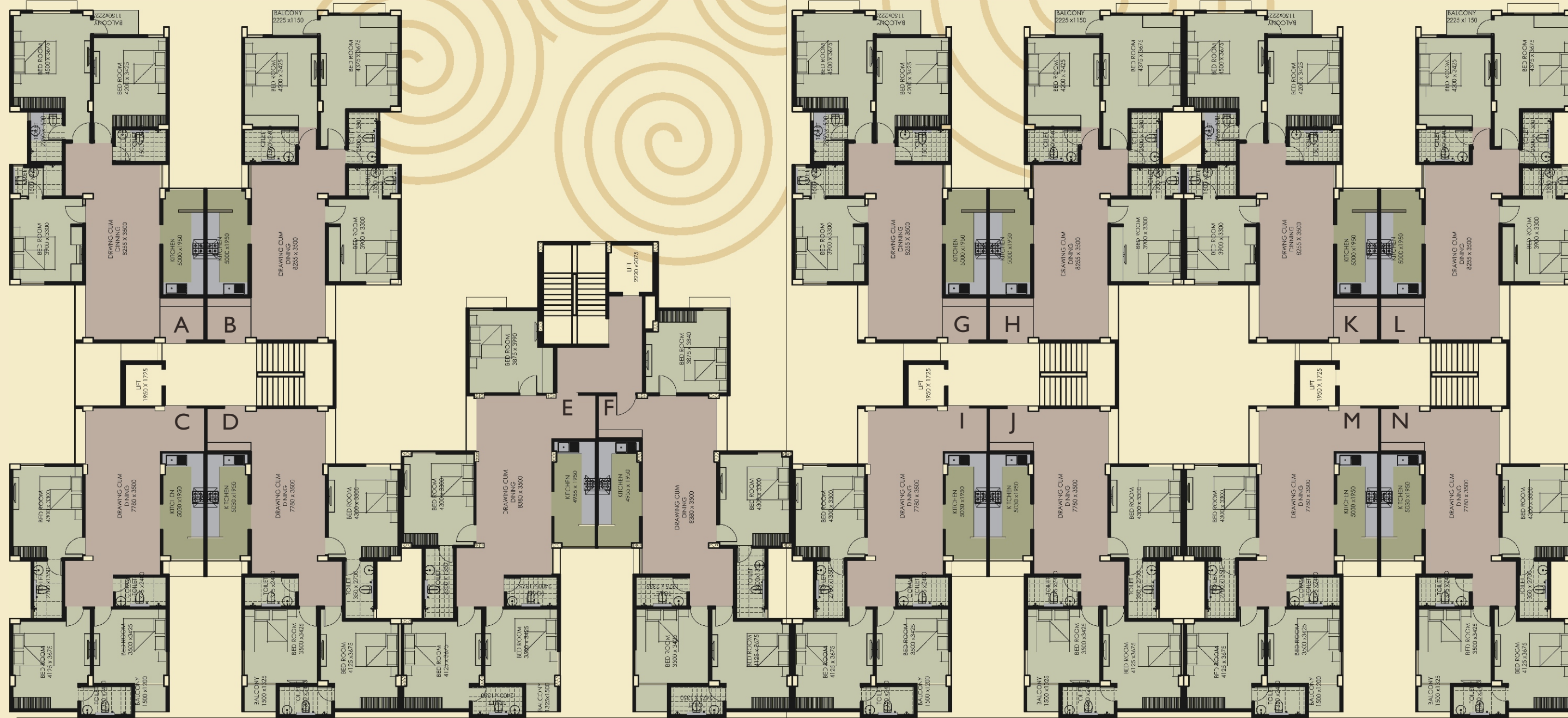

Landscaping



Location

Located in the heart of the city, the tower is very close to all your basic daily need from necessary commodities to luxury.

It is also close to shopping malls, multiplex theaters and other entertainment zones

